

## OUTDOOR **IP66** CABINETS

---



Suitable for IT and telecommunication solutions in outdoor conditions; protection against dust, accidental contact and water. Manufactured from DX51D+ZN275 material. Provides IP66 protection class by polyurethane seal on door. Resistant to vandalism with 3 point lock system provides. RAL7035 light gray polyester electrostatic powder paint is applied on the monoblock structure to protect the cabinet from corrosion, heat, icing and environmental influences. Insulation material available between single or double walled structure. Air condition available as option.



**Available in These Specified Heights** (in mm)  
*customized sizes available on request*

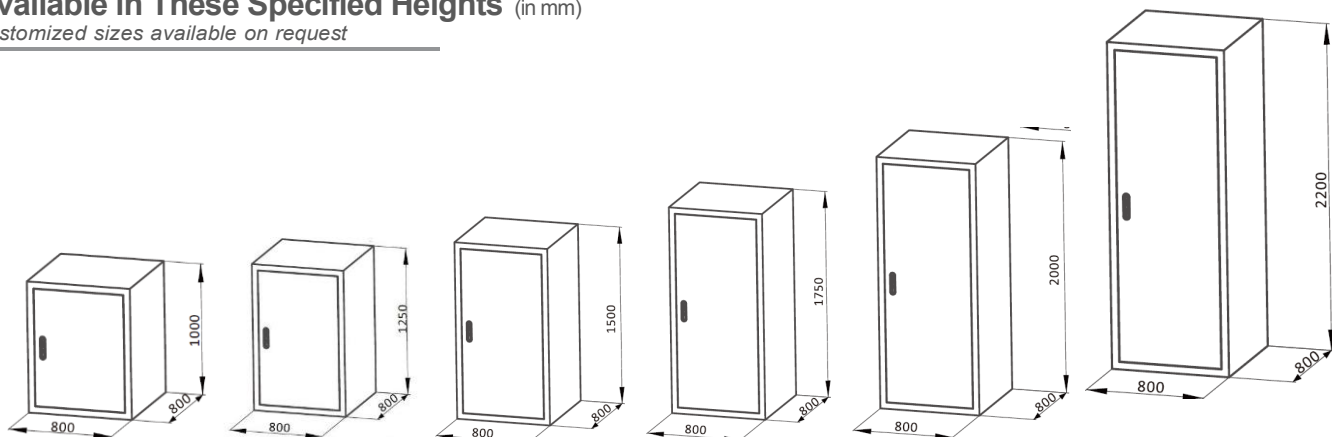

**Available in These Specified Depth** (in mm)

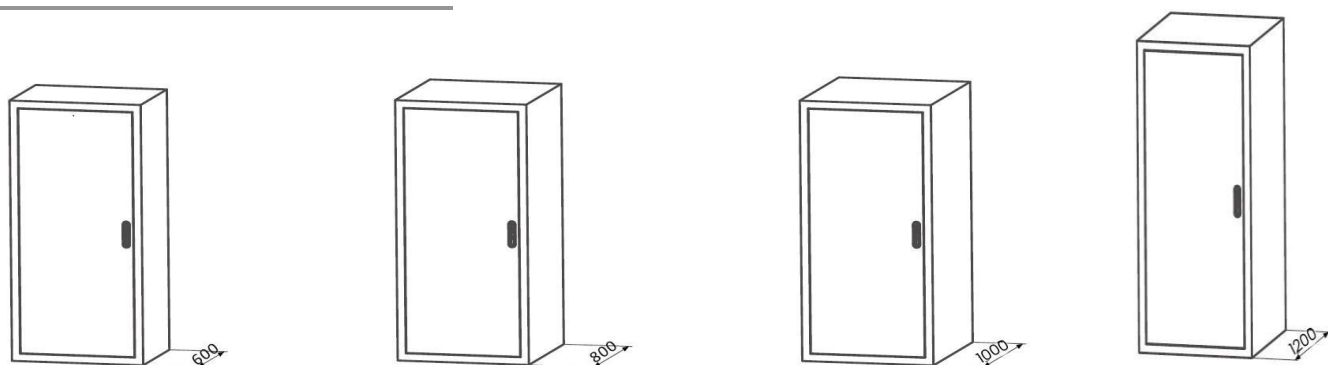

**Technical Performance**

Working temperature: -40°C ~ +75°C (Short time +100°C)
Storage temperature: -40°C ~ +75°C
Relative humidity: ≤ 95% (+ 40°C)
Atmospheric pressure: 70kpa ~ 106kpa

**Applications**

Telecommunication
Wireless / Broadband CATV
Base station
Solar based installations
Wireless cell sites & switches
Transmission terminals
Datacenter
Transportation

## Options

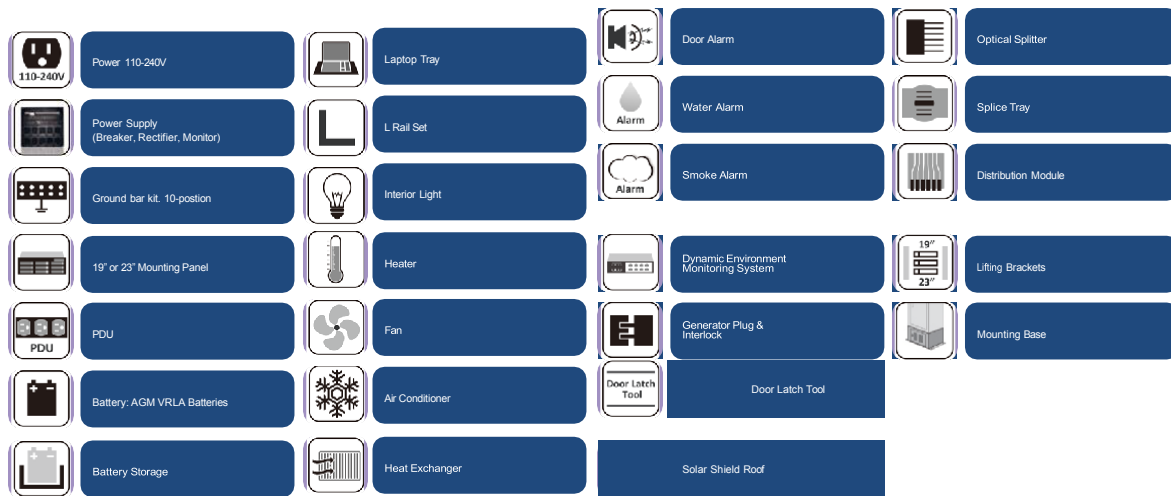

## Precautions for Installation and Use

- ✓ When possible, install the telecom cabinet in a well-ventilated and cool location with a clean surrounding environment to ensure optimal performance.
- ✓ Upon completing the cable installation, ensure that any gaps around the cables are sealed using the sealant provided with the cabinet. This prevents moisture intrusion, which could lead to condensation and compromise the equipment's functionality. The grounding bar must be securely connected to the ground, with a grounding resistance of less than 10  $\Omega$ .
- ✓ Regular maintenance is essential; clean the cabinet's ventilation and dust filters at least once a month. Depending on environmental conditions, the cleaning frequency may be adjusted as needed.

## Environmental

- ✓ Enclosures and thermal systems have powder coated finish to withstand the elements and provide superior environmental protection.

## Flexibility

- ✓ Constructed using durable materials such as galvanized steel, and stainless steel (SS304).
- ✓ Customizable color options, with RAL7035 as the standard. Other colors can be provided based on specified color codes.
- ✓ Offers a variety of advanced thermal management solutions tailored for demanding heat dissipation requirements, optimizing performance while minimizing energy consumption.
- ✓ Cooling system such as side cooler from 350W to 3.7KW.
- ✓ Highly adaptable, with a wide range of configuration possibilities, including PDUs, basic or Intelligent.
- ✓ Supports various environmental sensors, such as door sensors, smoke detectors, and temperature sensors, to enhance safety and monitoring.



### **Ventilation**

2 fans with thermostat on the top sheet ensure air circulation, fans provide hot air outlet and side filters allows cool air inlet.

### **Double Wall Structure**

Double-walled and insulated structure, provides high protection against accidental contact, vandalism, extreme thermal conditions and environmental impact. The outer wall is 1.5mm and the inner wall is 1.0mm, both of them DX51D+ZN275 galvanized steel. Considering environmental conditions and impact; double-walled, 8mm polyurethane thermal insulation material is used in the cabinets. This insulated structure is an effective solution to extreme weather conditions. Through ventilation slots on the forehead of cabinet cold, fresh air enter and fans are discharge the air. Thus decrease the temperature inside the cabinet prevents heat which may damage the active devices.

### **Water and Dust Proof**

Polyurethane gasket is available on the front door and top cover.

### **Locking Mechanism**

Three-point locking with zinc alloy metal swing handle provides full security against vandalism.

### **Protection Paint**

Polyester paint which is suitable for outdoor conditions applied. It protects against Environmental influence and weather conditions. Standard colour is RAL 7035 polyester outdoor paint. As an option, primer can be applied before painting for higher protection and longevity



Hot air outlet slots



### **19" Mounting Rails**

Mounting rails are adjustable along the depth of the cabinet. Made of 1.5mm DX51D+ZN275 material and "U" numbered for easy installation.

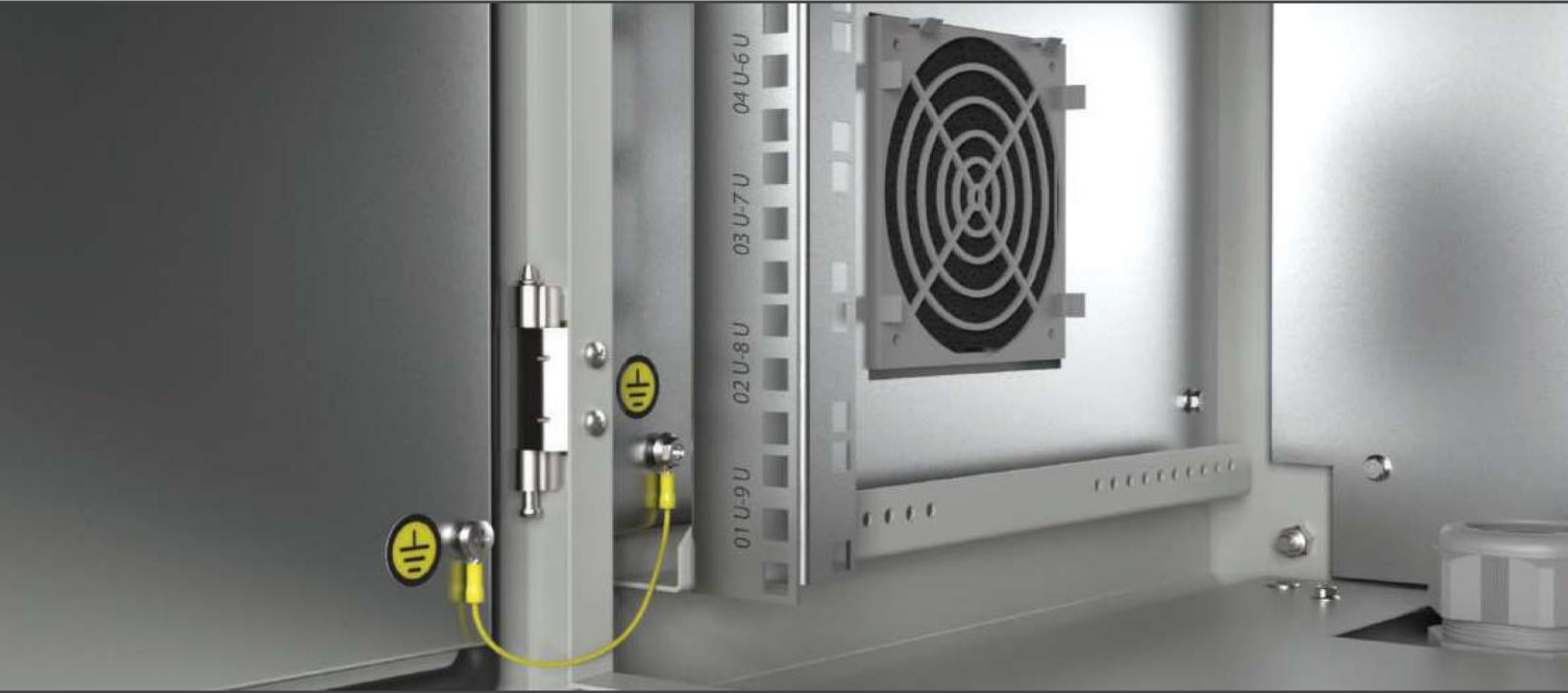

### **Filter System**

Through the side filter grids cold, fresh air enter and fans are discharge the heated air and humid. The cleanable and replaceable air filter is used in side filter grids

### **Bottom Cable Entry**

At the bottom cover of the outdoor cabinet brushed entry or cable glands entry can be used. Standard cable entry; 1XPG29, 2XPG21 and 2XØ28 PVC blind cap

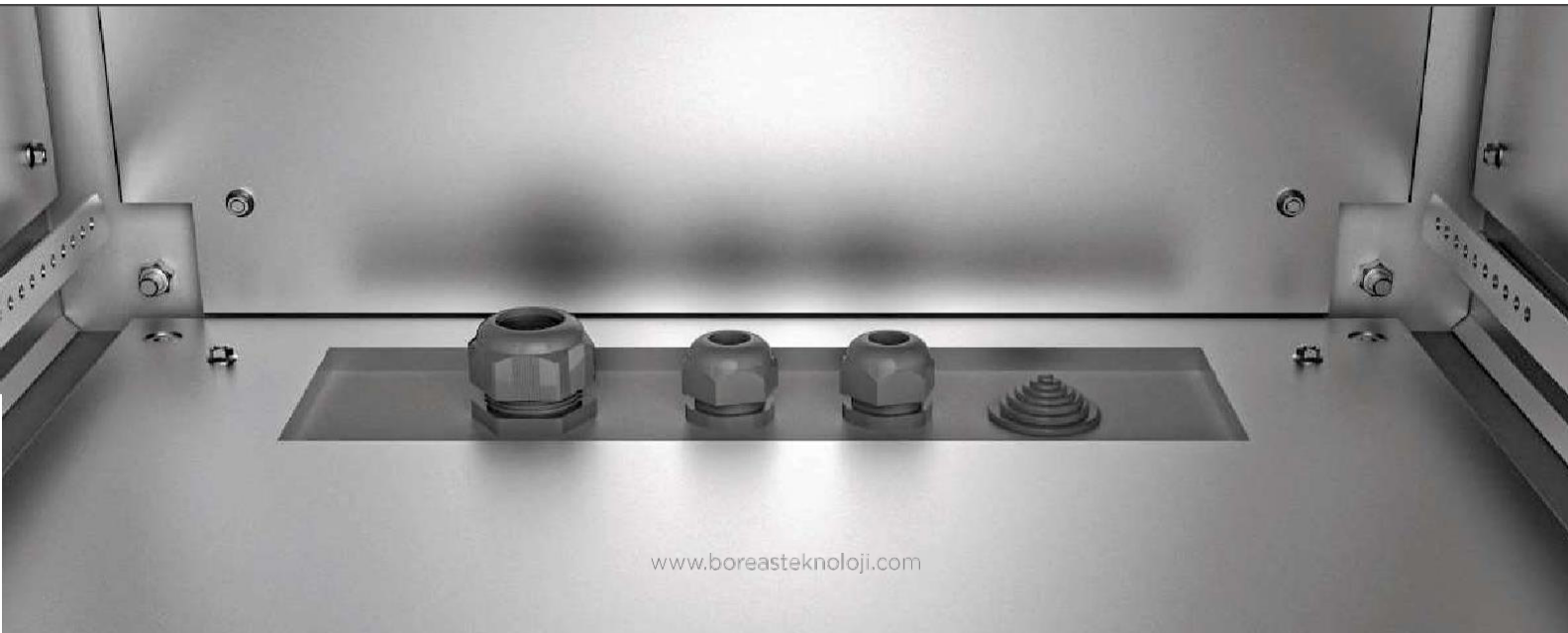

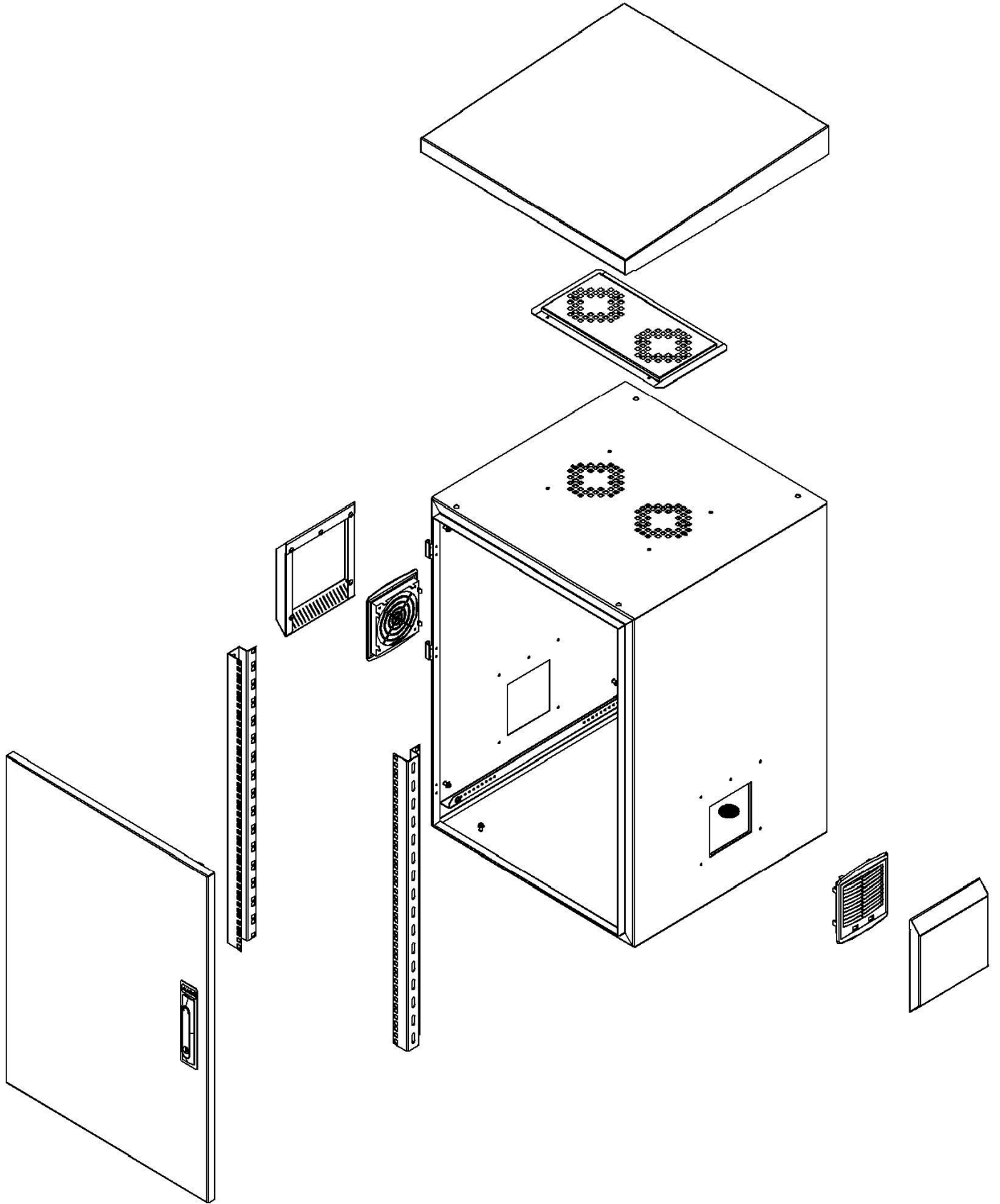

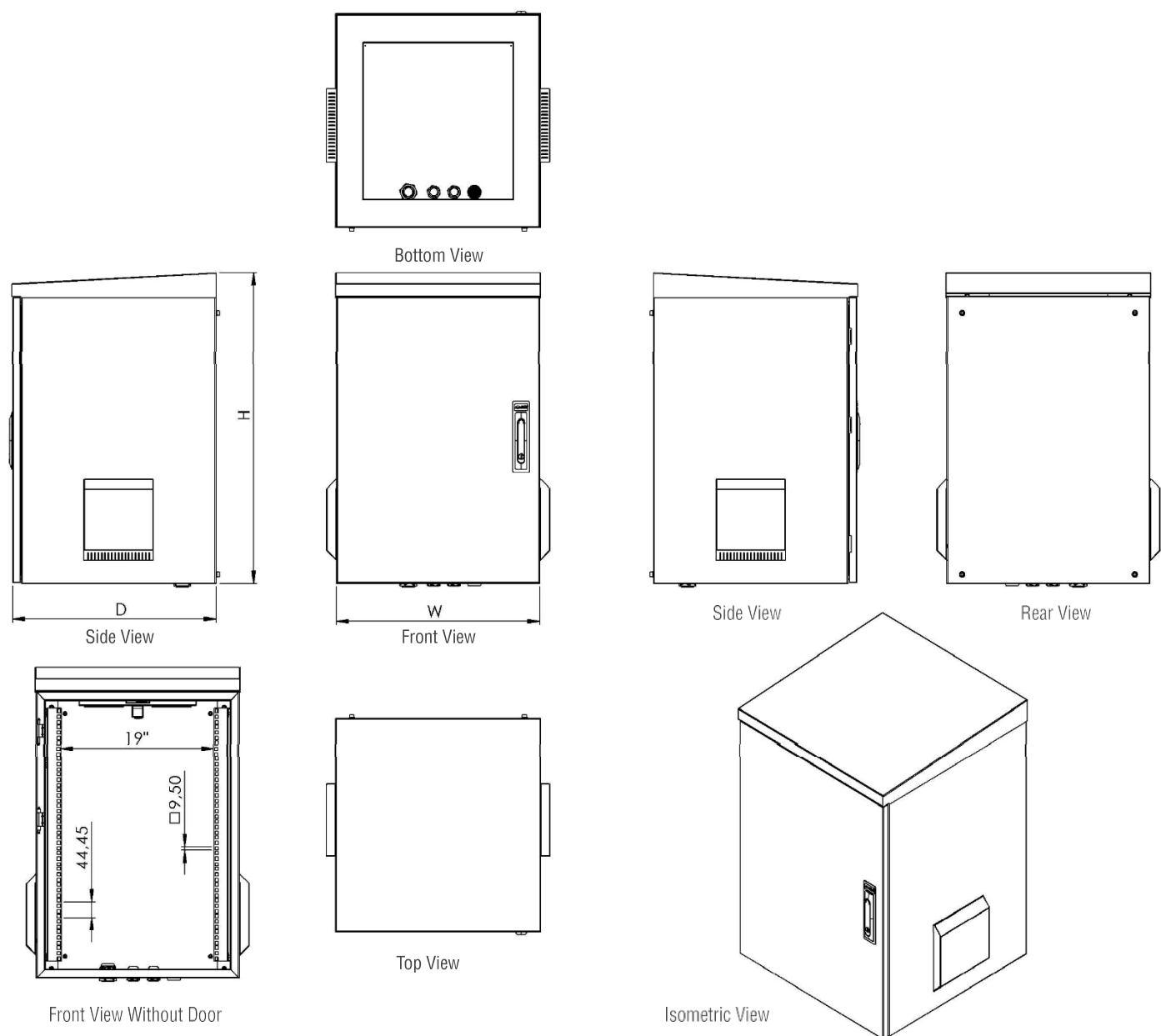

#### Outdoor IP66 Single Wall Cabinets

Product Code	Product Description	Height Size in (U)	Width (W) (mm)	Depth (D) (mm)	Height (H) (mm)	Weight (Net) (kg)	Weight (Gross) (kg)
BR-OT07U6045C3-D-A-X1	07U 19" IP66 Outdoor Wall Mounted Cabinet W=600mm D=450mm	7U	600	450	470	31	32
BR-OT09U6045C3-D-A-X1	09U 19" IP66 Outdoor Wall Mounted Cabinet W=600mm D=450mm	9U	600	450	559	33	34
BR-OT12U6045C3-D-A-X1	12U 19" IP66 Outdoor Wall Mounted Cabinet W=600mm D=450mm	12U	600	450	692	37	38
BR-OT24U6045C3-D-A-X1	24U 19" IP66 Outdoor Wall Mounted Cabinet W=600mm D=450mm	24U	600	450	1150	54	55
BR-OT07U6060C3-D-A-X1	07U 19" IP66 Outdoor Wall Mounted Cabinet W=600mm D=600mm	7U	600	600	470	37	38
BR-OT09U6060C3-D-A-X1	09U 19" IP66 Outdoor Wall Mounted Cabinet W=600mm D=600mm	9U	600	600	559	40	41
BR-OT12U6060C3-D-A-X1	12U 19" IP66 Outdoor Wall Mounted Cabinet W=600mm D=600mm	12U	600	600	692	43	45
BR-OT24U6060C3-D-A-X1	24U 19" IP66 Outdoor Wall Mounted Cabinet W=600mm D=600mm	24U	600	600	1150	62	63

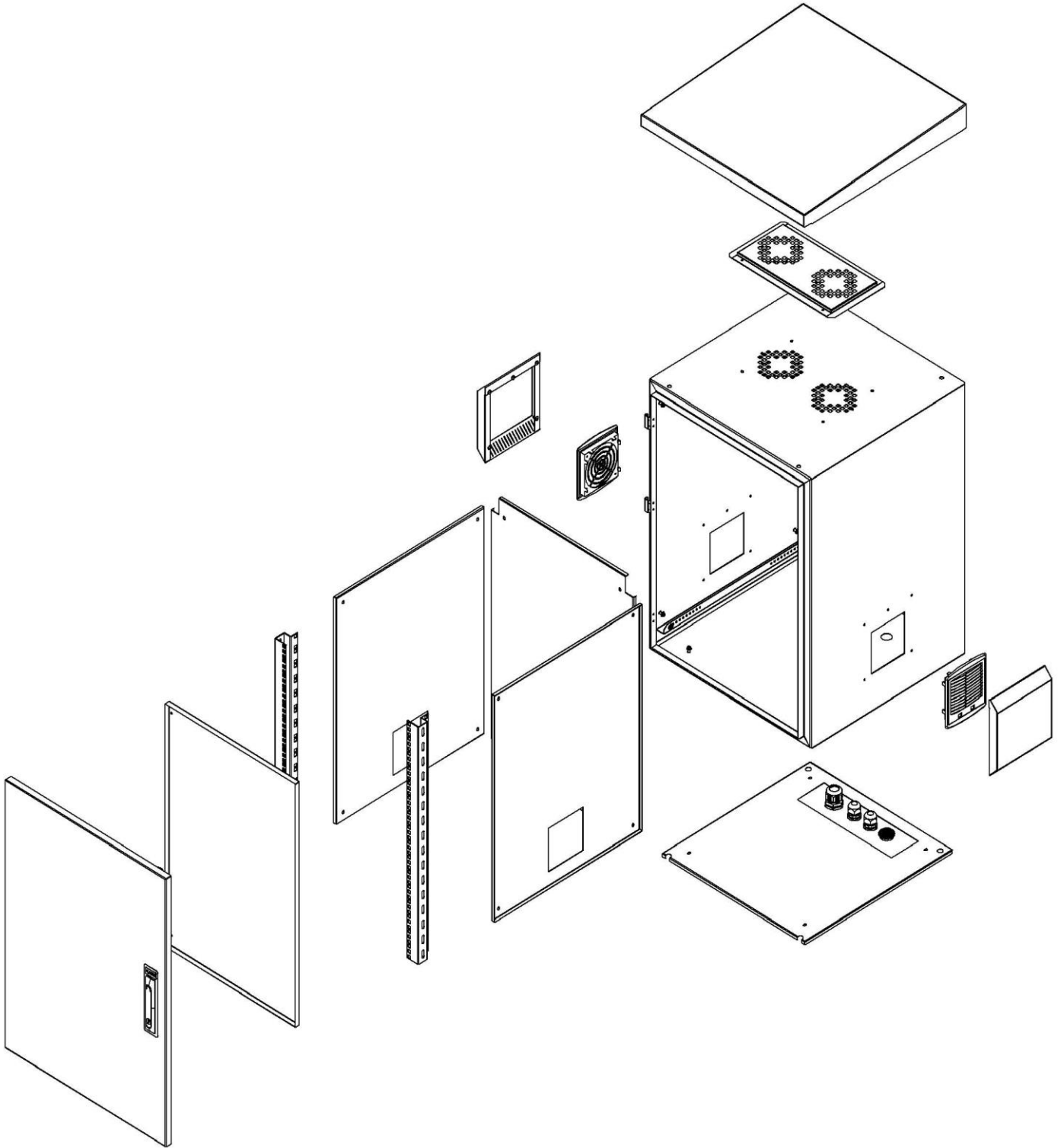

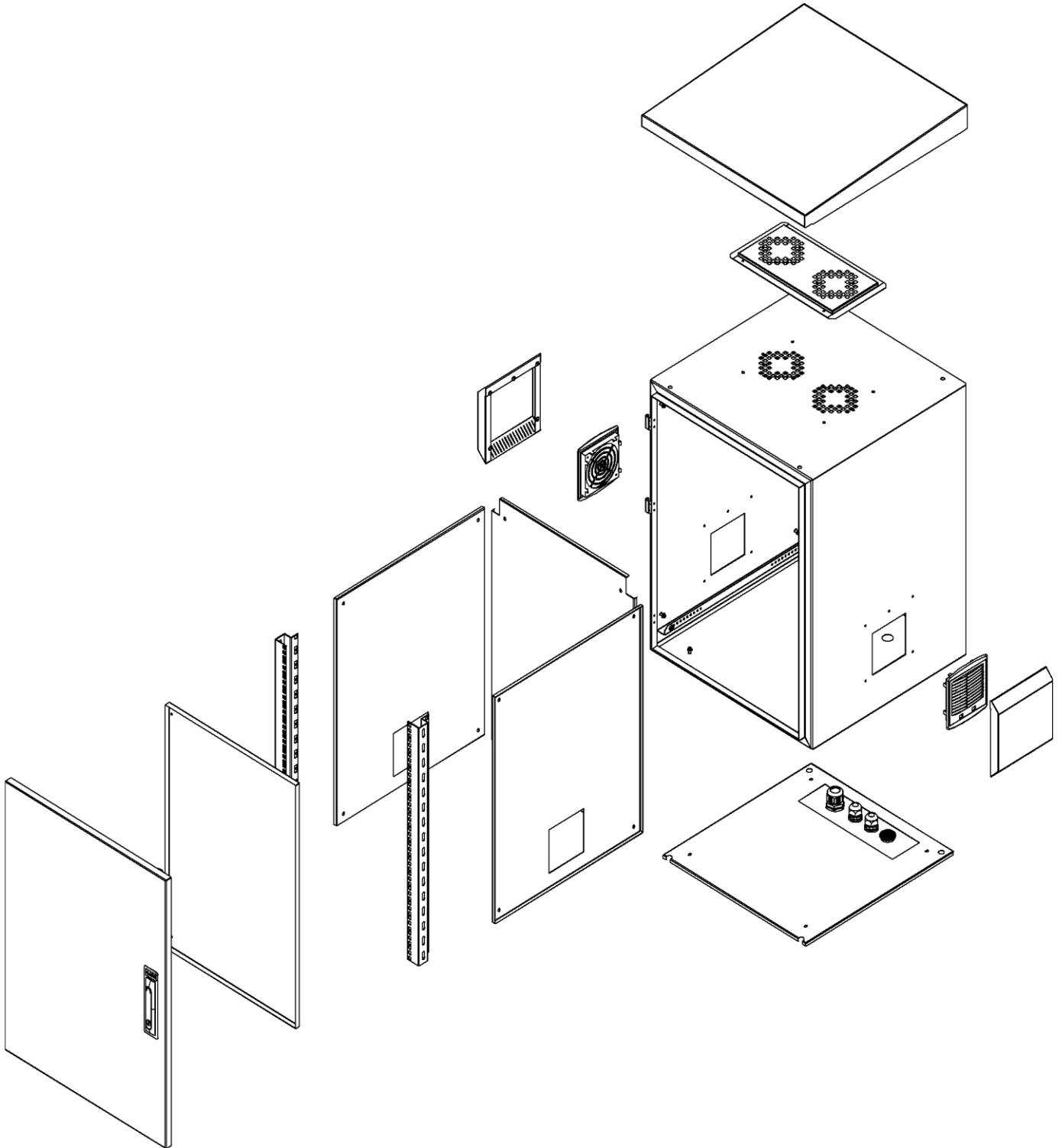

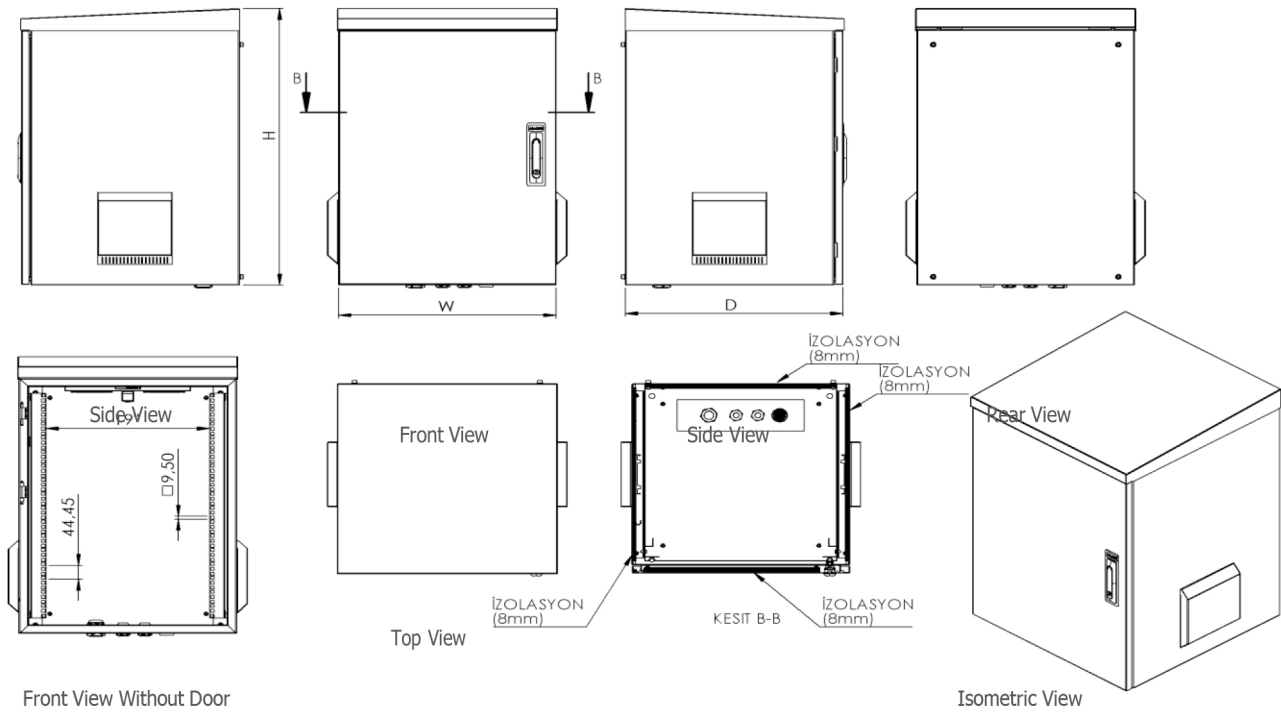

**\*\*For outdoor cabinets with IP66 rating, customization is available in both single-wall and double-wall configurations.**  
**\*\*Custom dimensions for width and depth are available, including options such as 800mm width and 800mm depth upon client request.**  
**\*\*Height customization is also possible; for example, we can provide cabinets in sizes like 32U.**

Outdoor IP66 Double Wall Cabinets								
Product Code	Product Description	Height Size (U)	Width (mm)	Depth (D) (mm)	Height (H) (mm)	Weight (Net) (kg)	Weight (Gross) (kg)	
BR-OD07U6045C3-D-A-X1	07U 19" IP66 Outdoor Wall Mounted Cabinet W=600mm D=450mm Double Wall (8mm between walls)	7U	600	450	470	35.8	336.8	
BR-OD09U6045C3-D-A-X1	09U 19" IP66 Outdoor Wall Mounted Cabinet W=600mm D=450mm Double Wall (8mm between walls)	9U	600	450	559	39.14	40.14	
BR-OD12U6045C3-D-A-X1	12U 19" IP66 Outdoor Wall Mounted Cabinet W=600mm D=450mm Double Wall (8mm between walls)	12U	600	450	692	45.12	46.12	
BR-OD16U6045C3-D-A-X1	16U 19" IP66 Outdoor Wall Mounted Cabinet W=600mm D=450mm Double Wall (8mm between walls)	16U	600	450	870	51.8	53.8	
BR-OD07U6060C3-D-A-X1	07U 19" IP66 Outdoor Wall Mounted Cabinet W=600mm D=600mm Double Wall (8mm between walls)	7U	600	600	470	42.53	43.53	
BR-OD09U6060C3-D-A-X1	09U 19" IP66 Outdoor Wall Mounted Cabinet W=600mm D=600mm Double Wall (8mm between walls)	9U	600	600	559	47.1	48.1	
BR-OD12U6060C3-D-A-X1	12U 19" IP66 Outdoor Wall Mounted Cabinet W=600mm D=600mm Double Wall (8mm between walls)	12U	600	600	692	52.3	54.3	
BR-OD16U6060C3-D-A-X1	16U 19" IP66 Outdoor Wall Mounted Cabinet W=600mm D=600mm Double Wall (8mm between walls)	16U	600	600	870	61.4	63.4	
BR-OD24U6060C3-D-A-X1	24U 19" IP66 Outdoor Wall Mounted Cabinet W=600 D=600 Double Wall (8 mm between walls)	22U	600	600	1052	46	47	